

**BPA**  
FREE ✓

**EU**  
SAFETY  
TESTED

**0+**  
MONTHS

# snookums

## ELECTRIC BREAST PUMP

FOR MODERN ON-THE-GO MOMS



QUOTE NAPPI CODE 272585\*001 TO CLAIM FROM MEDICAL AID, WHEN PURCHASED FROM A REGISTERED MEDICAL FACILITY LIKE A PHARMACY.

## PARTS:

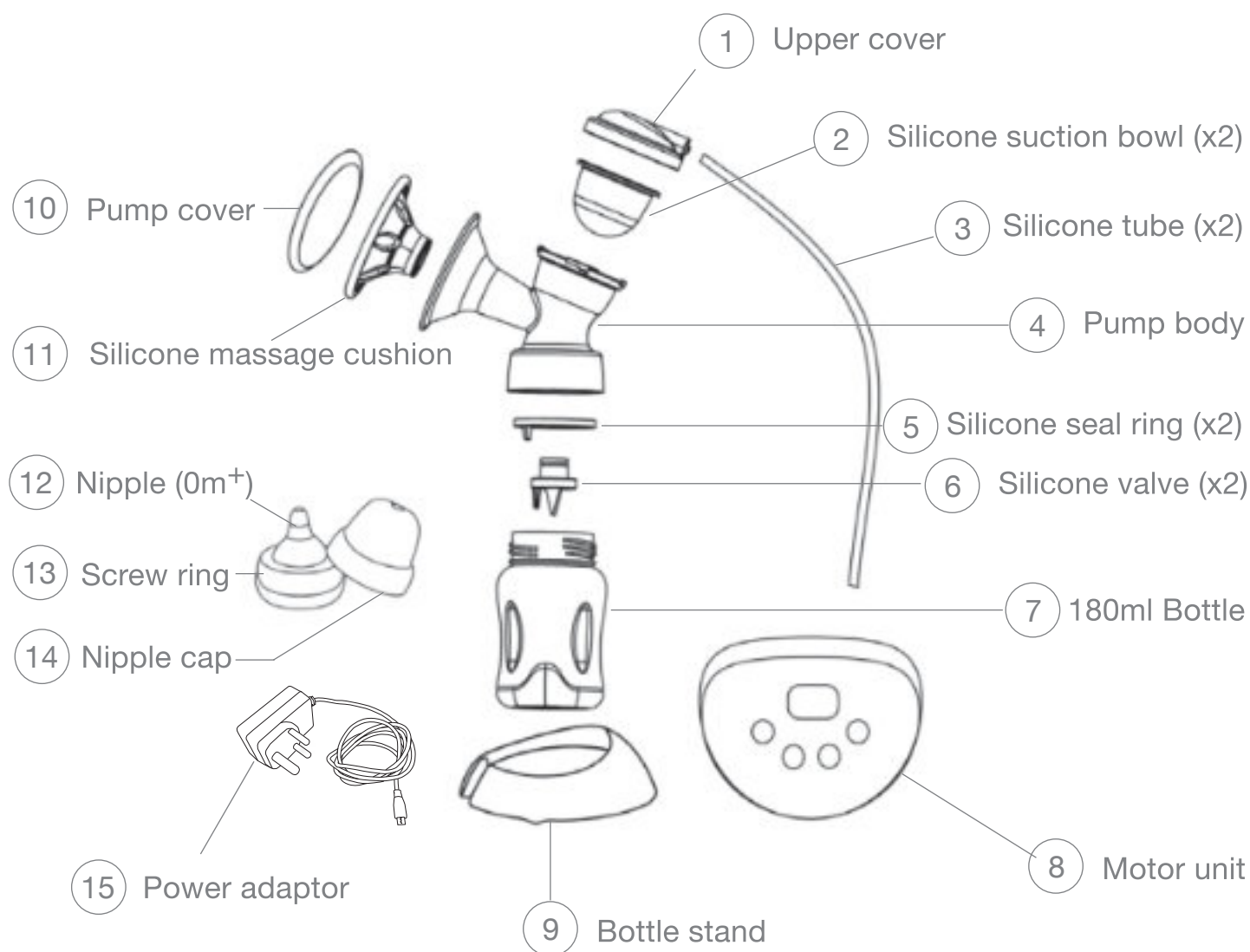

## CLEANING AND STERILISING:

Before using for the first time and after every use, disassemble the breast pump set into individual parts.

Then wash and sterilise all parts that come into contact with your breastmilk, to prevent bacteria growth (parts 2, 3, 4, 5, 6, 7, 11).

Before using the bottle and its parts for the first time, and also before each use, you must disassemble, wash and sterilise it (parts 7, 12, 13, 14).

Only use drinking-quality water for cleaning.

Take care when cleaning the silicone suction bowl (2) and the silicone valve (6). If it gets damaged, your breast pump will not function correctly. You can clean the parts by using the dishwasher (top rack only), or handwashing in warm, soapy water and then air drying parts. But sterilising the parts in a steam steriliser or by boiling for 5 minutes, is recommended.

Never wash or sterilise the motor unit (8), silicone tube (3), upper cover (1) and power adaptor (15). You can wipe the motor unit (8) clean with a soft cloth.

## ASSEMBLING YOUR BREAST PUMP:



Step 1: Place silicone massage cushion (11) over funnel of pump body (4)



Step 2: Insert the suction bowl (2) into the top of the pump body (4)



Step 3: Push the upper cover (1) on to the pump body (4)



Step 4: Insert the silicone valve (6) into the bottom of the pump body (4)



Step 5: Put the bottle (7) on to the pump body (4) and turn it anticlockwise to fix



Step 6: Firmly connect the silicone tube (3) to the upper cover (1)



Step 7: Firmly connect the silicone tube (3) to the motor unit (8)



Step 8: Connect the power adaptor (15) to the pump motor (8)



Step 9: Press the power switch (⏻) by holding it in for 2 - 3 seconds

## NOTE:

The battery might not be fully charged. First allow the battery to charge a few minutes by plugging into a power source.

If the silicone suction bowl (2) is wet, your breast pump will not function properly. The fully charged built-in lithium battery provides 1.5 hours of operation. You can use the breast pump without the power adaptor.

## USING YOUR BREAST PUMP:

### Before using:

Wash your hand thoroughly. Using your hands gently squeeze a little milk from each nipple to make sure that milk ducts are not blocked.  
Relax in a comfortable chair, leaning slightly forward.



### To begin pumping:

Press the funnel and massage cushion of the pump, firmly against your breast. There should be no air escaping, otherwise there will be no suction.

Press the power switch and hold in for 2 - 3 seconds. The black background screen is now on and indicates the massage sign on the right side, and the timer is running from 00:01 to 02:00.

The breast pump automatically starts with the lowest massage strength, and will run this for 2 minutes. Once your milk starts flowing, you can change the massage strength by using the increase (+) or decrease (-) buttons.

You can also change the suction strength by using the increase (+) or decrease (-) buttons. Press the mode exchange button to toggle between massage strength and suction strength.

When you are done expressing, press the power button to switch off the breast pump, and carefully remove the pump from your breast.

Disconnect the motor unit from the pump. Unscrew the bottle from the pump body and store or use the expressed breastmilk.

### Note:

The unit will automatically shut down after 30 minutes of use. This is to protect the pump, and the mother.

When the lithium battery voltage is less than 3.4V, the display will darken as a reminder that the user must recharge the unit. The battery needs to charge for 2 hours to be fully charged, and will then last for 1.5 hours.

Do not continue pumping for more than 5 minutes if there are no results. Rather try expressing at another time.

If the process becomes uncomfortable or painful, stop use immediately and consult your breastfeeding advisor.

Never tilt the breast pump when the milk has reached the maximum line on the bottle, as the milk will run into the pump, and it will stop working

## STORING THE EXPRESSED BREASTMILK:

Breastmilk Storage Guide				
Room temperature 19 - 20°C	Cooler with Frozen Ice Packs 15°C	Refrigerator 4°C	Freezer -18°C	Thawed Breastmilk
4 - 6 hours	24 hours	3 - 8 days	6 - 12 months	use within 24 hours

NOTE: If the temperature in the place you are expressing in, is more than 25°C, chill milk immediately to keep it fresh.

### Defrosting breastmilk:

Thaw breastmilk in the refrigerator overnight, or hold the bottle under warm water to speed up the thawing process.

Do not refreeze thawed milk. It is safe to keep thawed milk in the refrigerator for 24 hours.

Never thaw frozen breastmilk in microwave or in a pan with boiling water. Never microwave breastmilk, as it changes the composition of the breastmilk. Hotspots may also occur and can cause severe burns to your baby's mouth.

When adding expressed breastmilk to already frozen milk, add a smaller amount than the already frozen amount.

## TROUBLESHOOTING:

### Lack of suction

Check that all components are assembled correctly, and that the silicone valve is in the correct position.

Ensure the upper cover (1), suction bowl (2) and the silicone massage cushion (11) are all fitted securely to the pump body (4) and a perfect seal is created. Make sure the silicone tube (3) is firmly connected to the upper cover (1) and the motor (8), and that it is not twisted. Ensure the silicone seal ring (5) forms a perfect seal between the pump body (4) and the bottle (5).

### Motor unit automatically stops

If the motor unit automatically stops functioning and switches off, this means the breast pump battery is flat and needs to be recharged. You would have seen the battery indicator showing only 1 bar before it switched off.

Recharge the battery and switch the pump on again.



When using the power adapter to supply power, make sure it is connected properly, then switch the pump on again.

Milk is drawn up the massage cushion

Remove, clean and dry the massage cushion. Refit it, and make sure it is installed correctly. Lean slightly forward while expressing.

## WARNING:

To extend the life of your breast pump, please pay attention to the following:

Keep out of reach of children. Always use under adult supervision.

Do not place or drop the motor unit, silicone tube or power adaptor into water or other liquids.

The breast pump is not heat-resistant, keep away from radiators and open flames.

Do not expose the motor unit to direct sunlight.

**BREASTMILK IS THE BEST FOOD FOR YOUR BABY.**

This product is not always sterile and might contain microorganisms. It must be prepared, sterilised and cleaned appropriately.

If you are breastfeeding your baby, using a feeding bottle and teat may interfere with baby's natural sucking of the breast.

Never use a damaged device, immediately replace damaged or worn parts.

This is a single user product. Use by more than one person may present a health risk.

Always unplug from power socket immediately after use.

Do not use the breast pump while drowsy, sleeping, driving or bathing.

Do not use organic solvents or detergents to clean the breast pump.

Remember to closely follow the breastmilk storage guide to ensure optimum breastmilk freshness.

## WARRANTY:

Snookums offers customers a 12 month warranty on motor unit from date of purchase.

Proof of purchase is required by way of valid slip.

This warranty becomes void if product was used commercially or was subject to misuse, abuse or alteration.

## MEDICAL AID:

This item can be claimed from your Medical Aid. Quote the AdvaCare Snookums Nappi Code 272585\*001, when purchased from a registered medical facility like a pharmacy.

## SNOOKUMS BABY PRODUCTS:

Postnet 265, Private Bag X13  
Brackenfell, 7561  
South Africa

[www.snookums.co.za](http://www.snookums.co.za)  
[info@snookums.co.za](mailto:info@snookums.co.za)  
Customer Care: 086 101 8885