

**BPA**  
FREE ✓

**EU**  
SAFETY  
TESTED

**0+**  
MONTHS

# snookums

## DOUBLE ELECTRIC BREAST PUMP

WHISPER QUIET MULTI-PHASE SUCTION



QUOTE NAPPI CODE 1080332001 TO CLAIM FROM MEDICAL AID, WHEN PURCHASED FROM A REGISTERED MEDICAL FACILITY LIKE A PHARMACY.

## PARTS:

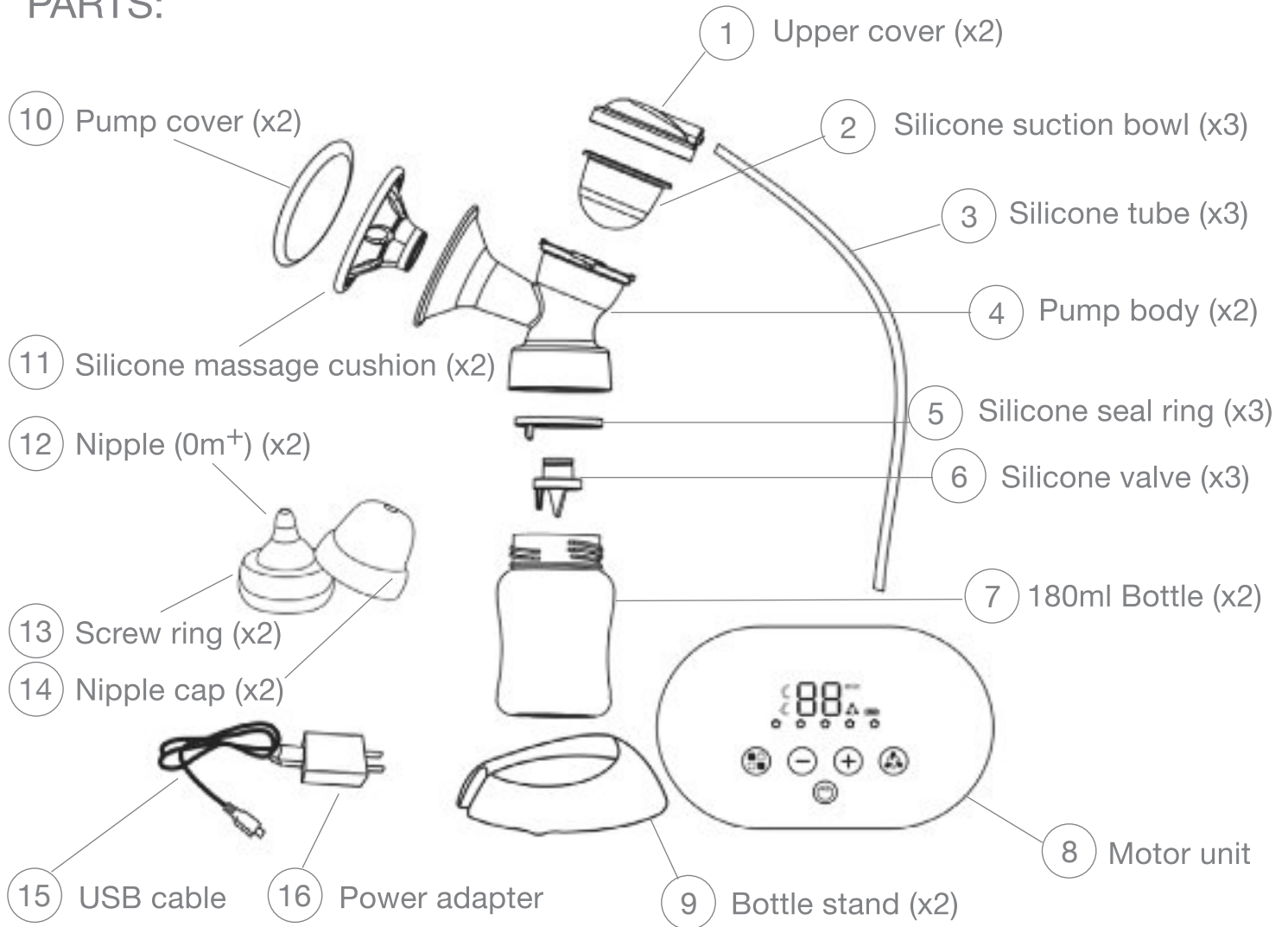

## CLEAN AND STERILIZE:

- Before using for the first time and after every use, disassemble the pump set into individual parts, wash and sterilize all the breast pump parts that come into contact with your breast milk (parts 2, 3, 4, 5, 6, 7, 11).
- Before using the bottle and its parts for the first time and before each use, you must also disassemble, wash and sterilize (parts 12, 13, 14).

### Caution

- Only use water suitable for human consumption for cleaning.
- Take apart and wash all parts that come in contact with breast and breast milk immediately after use to avoid drying of milk residues and to prevent growth of bacteria.
- Take care when cleaning the silicone suction bowl and the silicone valve. If it gets damaged, your breast pump will not function properly.

### Warning

- Never wash or sterilize the motor unit, the silicone tube, the upper cover and the power adapter. You can wipe the motor unit clean with a soft cloth.
- You can also use the dishwasher (top rack only) or hand wash in warm, soapy water, and then dry with a clean cloth or leave to dry on a clean cloth.
- We recommend that you sterilize all the necessary parts in the steam sterilizer, or by boiling for 5 minutes.

## ASSEMBLING YOUR BREAST PUMP:



Step 1: Place silicone massage cushion (11) over funnel of pump body (4)



Step 2: Insert the suction bowl (2) into the top of the pump body (4)



Step 3: Push the upper cover (1) on to the pump body (4)



Step 4: Insert the silicone valve (6) into the bottom of the pump body (4)



Step 5: Put the bottle (7) on to the pump body (4) and screw it securely closed



Step 6: Firmly connect the silicone tube (3) to the upper cover (1)



Step 7: Firmly connect the silicone tube (3) to the motor unit (8)

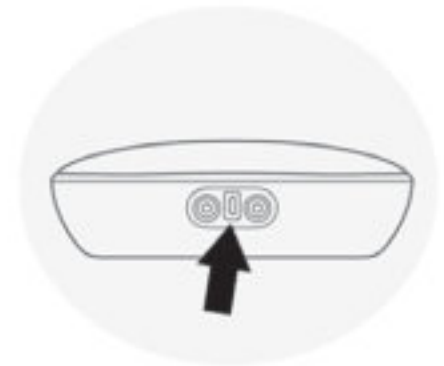

Step 8: Connect the power adaptor (16) to the pump motor (8)



Step 9: Press the power switch by holding it in for 2 - 3 seconds

### NOTE:

- If the silicone suction bowl (2) is wet, your pump will not function properly.
- The fully charged built-in lithium battery provides 1.5 hours of operation. You can use the breast pump without the power adaptor.

## BEFORE USING THE PUMP:

- You should fully charge the device before using for the first time.
- Wash your hands thoroughly and make sure your breasts are clean.
- Gently squeeze a little milk from each nipple to make sure that milk ducts are not blocked.
- Make sure you follow the steps in “Clean and Sterilize” and “Assembling Your Breast Pump” chapters to clean, sterilize, and assemble the device.
- Relax in a comfortable chair leaning slightly forward.



## 2-PHASE EXPRESSION TECHNOLOGY:

### 1 Stimulation Phase (Let-down function)

- No milk flow
- Fast pumping pattern to stimulate milk flow

### 2 Expression Phase

- Milk flow
- Slower and stronger pumping pattern.
- Proven to get more milk in less time.

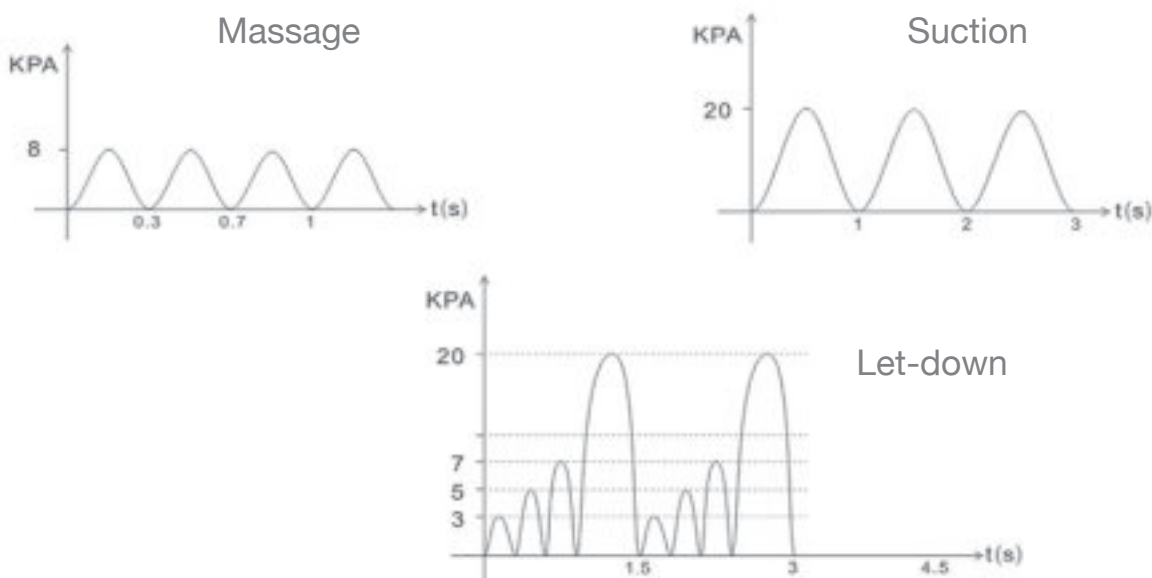

## 3-FUNCTION WORKING PRINCIPLE DIAGRAM



## TO BEGIN PUMPING:

- Press the funnel and let-down massage cushion of the pump firmly against your breast. Make sure that no air escapes, otherwise there is no suction.
- Press the power switch  to switch on your pump. The screen is on and indicates the massage sign at the right side. The above timer is running from 00:01 to 02:00. The breast pump automatically starts up with the lowest massage for 2 minutes. There are 5 levels of massage intensity. You can change the mode freely from 1 to 5 by pressing the increase button “+” or pressing the decrease button “-” and find the perfect setting which you are comfortable with.
- The appliance transfers to the suction automatically after 2 minutes by default.

Once your milk starts flowing, you can press suction increase button “+” or suction decrease button “-” to adjust and find your level of comfort.

- Press “+” to deeper the suction, press once to increase 1 grade. Press “-” to lower the suction, press once decrease 1 grade, there are 5 grades.
- You can change to the suction mode manually by the mode change key .
- The screen indicates which mode you are using.
- When you have finished expressing, press  to switch off your pump. Carefully remove the pump body from your breast.
- Disconnect the power plug from the power socket and then disconnect the power adapter from the pump.
- Unscrew the bottle from the pump body ready for feeding or storage. Clean the other used parts of the breast pump according to the instructions in the chapter “Clean and Sterilize”.

### Note

- You do not need to use the deepest suction mode, only use the modes that are comfortable for you.
- If you can express more than 120ml each time, use a 240ml milk bottle (sold separately) for storage to avoid spillage.
- The unit will shutdown automatically after 30 minutes to protect the mother and the pump.
- When the lithium battery voltage is less than 3.4V, the display will indicate low power to remind the user to recharge the unit. A full recharge takes 1 hour, and the usage lasts for 1.5 hours.

### Caution

- Do not continue pumping for more than 5 minutes at a time if there is no result. Try expressing at another time during the day.
- If the process becomes very uncomfortable or painful, stop using the pump and consult your breastfeeding advisor.
- Never tilt the breast pump when the milk has reached the maximum line on the bottle. Replace with a new bottle before re-pumping to avoid spillage.
- Place the pump motor on a stable and flat surface to avoid any accidental drops when in use. If not, this may pull the pump body off from the breast and cause injury.

## STORING THE EXPRESSED BREAST MILK:

Breast Milk Storage Guide				
Room temperature 19 - 20°C	Cooler with Frozen Ice Packs 15°C	Refrigerator 4°C	Freezer -18°C	Thawed Breast milk
4 - 6 hours	24 hours	3 - 8 days	6 - 12 months	use within 24 hours

NOTE: If the temperature in the place you are expressing in is more than 25°C, chill milk immediately to keep it fresh.

### Defrosting breast milk

- Thaw breast milk in the refrigerator overnight, or hold the bottle under warm water to speed up the thawing process.
- Do not refreeze thawed milk. It is safe to keep thawed milk in the refrigerator for 24 hours.
- Never thaw frozen breast milk in a microwave or in a pan with boiling water.
- Never microwave breast milk, as it changes the composition of the breast milk. Hotspots may also occur and can cause severe burns to your baby's mouth.
- When adding expressed breast milk to already frozen milk, add a smaller amount than the already frozen amount.

### WARRANTY:

- Snookums offers customers a 12 month warranty on the motor unit from date of purchase.
- Proof of purchase is required by way of a valid slip.
- This warranty becomes void if product was used commercially or was subjected to misuse, abuse or alteration.
- No exchanges or refunds will be done. Only the faulty parts or components will be replaced.

### MEDICAL AID:

- This item can be claimed from your Medical Aid. Quote the AdvaCare Snookums Nappi Code 1080332001, when purchased from a registered medical facility like a pharmacy.

### SNOOKUMS BABY PRODUCTS:

Postnet 265, Private Bag X13  
Brackenfell, 7561  
South Africa

[www.snookums.co.za](http://www.snookums.co.za)  
[info@snookums.co.za](mailto:info@snookums.co.za)  
Customer Care: 086 101 8885



## TROUBLESHOOTING:

### **Lack of suction**

- Check that all components are assembled correctly and that the silicone valve (6) is in the correct position.
- Ensure the upper cover (1), suction bowl (2) and the silicone massage cushion (11) are all fitted securely to the pump (4) to ensure a perfect seal is created.
- Make sure the silicone tube (3) is firmly connected to the upper cover (1) and the motor (8) and that it is not twisted. Ensure the silicone seal ring (5) forms a perfect seal between the pump body (4) and the bottle (5).
- If the air pressure in your region is too low this may affect the suction.

### **No milk being expressed**

- Make sure the pump is assembled correctly and the suction is created.
- Relax and try again, as expression may improve with practice.

### **Pain in the breast area when expressing**

- You may be pumping too hard. You do not need to use all the suction that the pump can generate, only the most comfortable mode and setting. Press the suction decrease button “-” to lower down the suction intensity.
- Consult your health professional/breast feeding advisor.

### **Milk is drawn up the let-down massage cushion**

- Remove and refit the let-down massage cushion. Make sure that it is installed correctly and firmly. Try leaning lightly forward.

### **Components broken or lost**

- Certain spare components are provided, please contact the Customer Care Center at 086 101 8885 for any further spare components.

### **Pump lights are showing low voltage warning**

- If the light on the screen are sequentially flashing and the pump motor has stopped functioning, this means the breast pump is in low voltage protection mode. If you use the batteries to supply power, press the on/off switch to switch off. Recharge the battery and switch the pump on again. When using the power adapter to supply power, make sure it is connected properly, then switch the pump on again. If this problem persists, contact the Consumer Care center for help.

### **Motor unit automatically stops**

- If the motor unit automatically stops functioning and switches off, this means the breast pump battery is flat and needs to be recharged. You would have seen the battery indicator showing only 1 bar before it switched off.
- Recharge the battery and switch the pump on again.
- When using the power adapter to supply power, make sure it is connected properly, then switch the pump on again.
- Milk is drawn up the massage cushion
- Remove, clean and dry the massage cushion. Refit it, and make sure it is installed correctly. Lean slightly forward while expressing.

## WARNING:

To extend the life of your breast pump, please pay attention to the following:

- Leave the breast pump out of the reach of children.
- Do not place or drop the pump motor, silicone tube and power adapter in water or other liquids.
- The breast pump is not heat-resistant, keep away from radiators and open flames.
- Do not expose the motor unit to direct sunlight.
- Repairs must be performed only by an authorized service agency. Do not repair by yourself. No modifications to the device are permitted.
- Never use a damaged device. Replace damaged or worn parts.
- Always unplug from the power socket immediately after use.
- Do not use the breast pump while bathing.
- Do not use the breast pump while drowsy, sleeping, driving or bathing.
- This is a single user product. Use by more than one person may present a health risk.
- Do not drive whilst hands-free pumping.
- If you experience pain in the breast or nipple during use please stop using.
- This appliance is not intended for use by persons, including children, with reduced physical, sensory or mental capabilities, or lack of experience or knowledge, unless they have been given supervision or instruction concerning use of the appliance by a person responsible for their safety.
- While breast pump is in use, please adjust levels of suction and massage to personal comfort.
- Please clean and sterilize again before or after use. Pay attention to keep clean, sterilize in time (except for electronic unit and adapter).
- Do not use organic solvents or detergents to clean the breast pump.
- Remember to closely follow the breast milk storage guide to ensure optimum breast milk freshness.
- Use this product only for the intended purpose as directed in this manual.

## BREAST MILK IS THE BEST FOOD FOR YOUR BABY:

- This product is not always sterile and might contain micro-organisms. The breast pump must be prepared, sterilised and cleaned appropriately.
- If you are breastfeeding your baby, using a feeding bottle and teat may interfere with baby's natural sucking of the breast.

## RECYCLING:

- Batteries contain substances that may pollute the environment. Do not throw away batteries with the normal household waste, but dispose them at an official collection point for batteries. Do not throw away the appliance with the normal household waste. Please get to know the local regulation for electrical and electronic products. By disposing in the correct way, you help to avoid causing a negative impact on the environment and human health.